

KHASRA MAP  
SCALE 1:4000

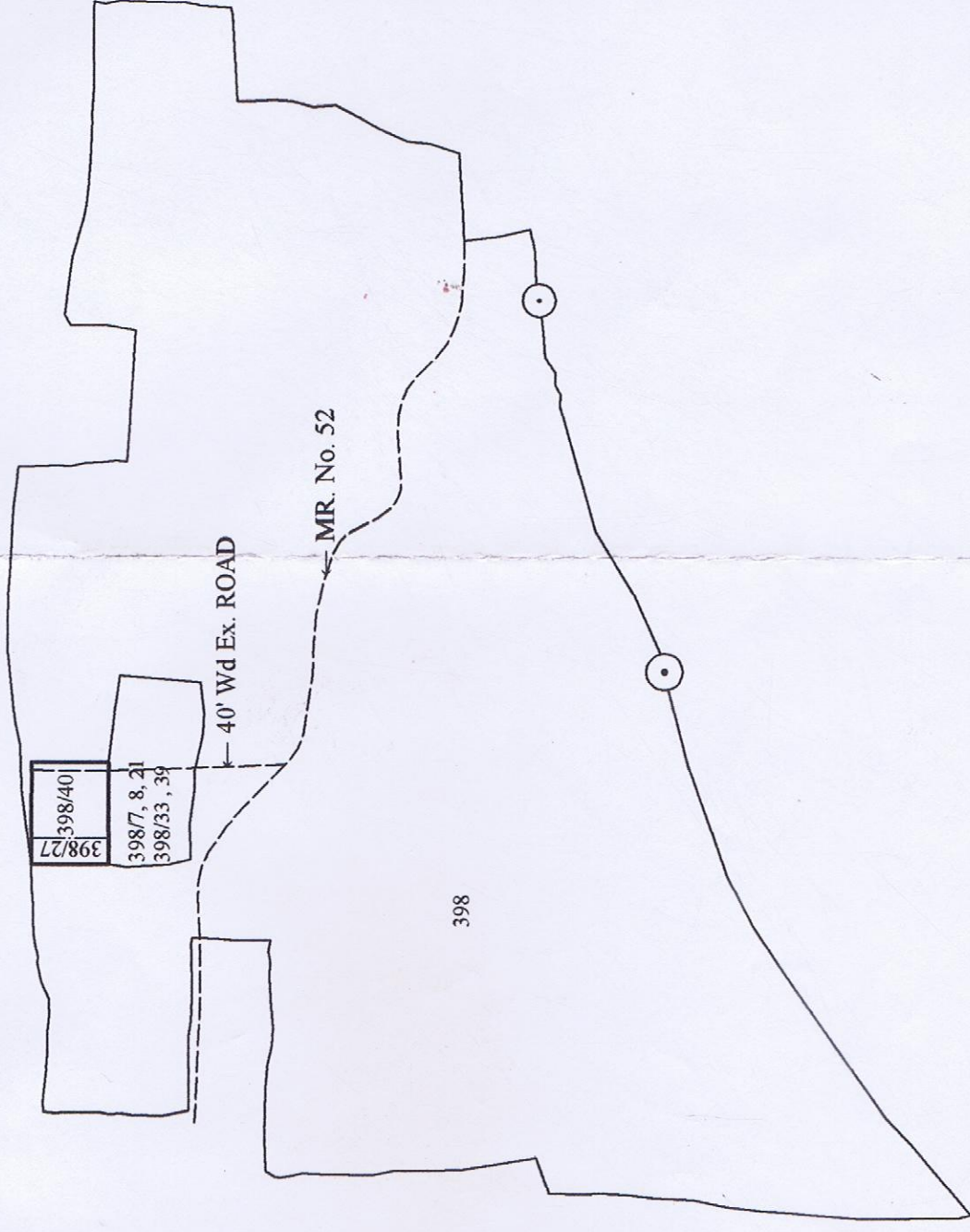

**विकास अनुज्ञा**  
**आवासीय उपयोग हेतु**

Valid up to 20/5/15

पत्र क्रमांक 6410 दि. 20/5/15 का सहपत्र है।

संयुक्त संचालक,  
नगर तथा ग्राम निवेश,  
क्षेत्रीय कार्यालय, रायपुर (छ.ग.)

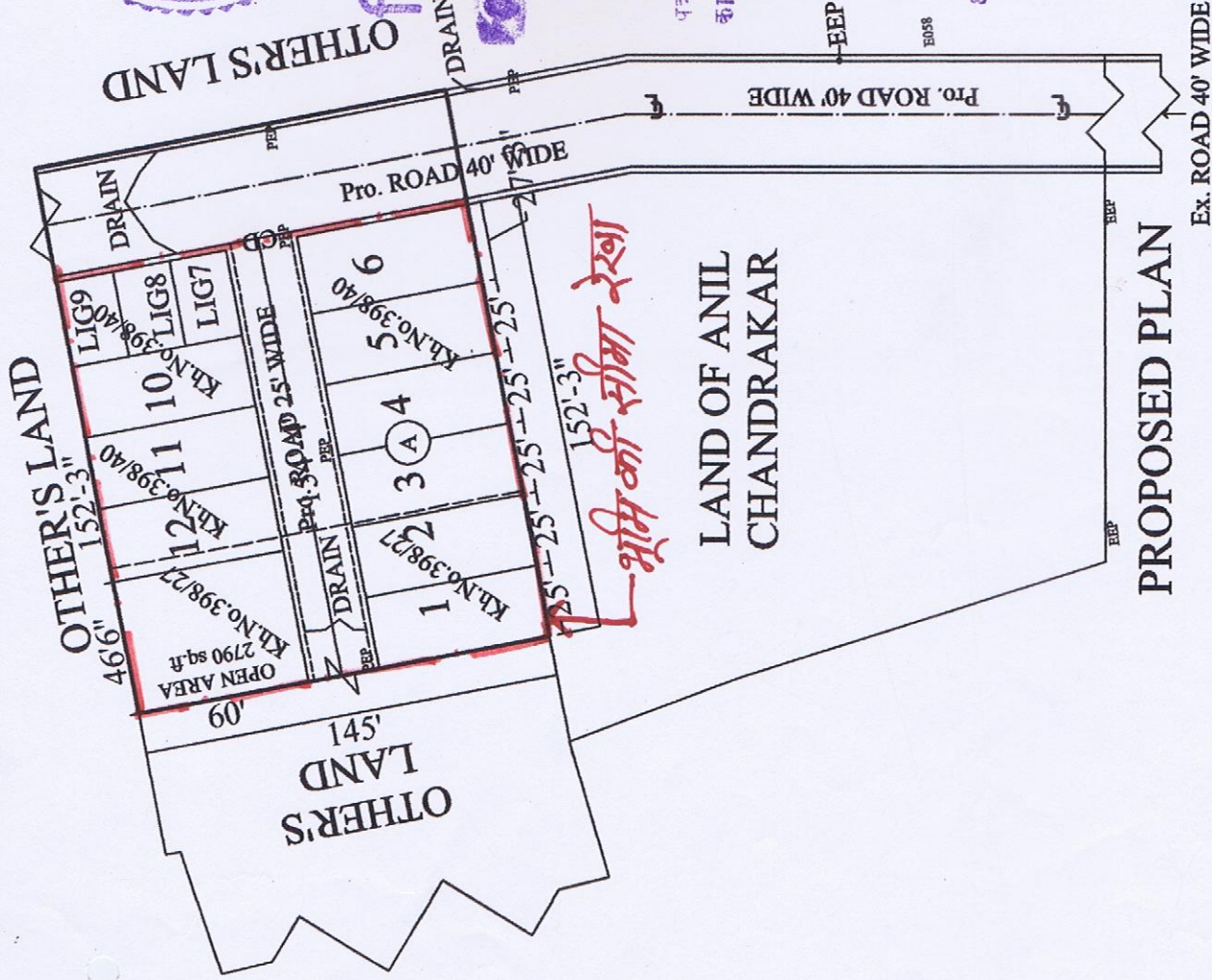

**PROPOSED PLAN**

NOTE - PLOT No L.I.G.7,8,9 FOR LOW INCOME GROUP

ORIENTATION N	SCALE - 1/64" = 1' ; 1:768
	<p>NOTE - PLAN AREA MARKED IN RED EEP = EXISTING ELECTRIC POLE PEP = PROPOSED ELECTRIC POLE C.C. = CROSS COMMUNICATION WORK CD = CROSS DRAINAGE WORK HP = HUMP PIPE CULVERT ----- = PROPOSED DRAIN ε = CENTER LINE</p>

<p>AREA STATEMENT PLOT Kh. No. 398/27 = 0.069 Hect, PLOT Kh. No. 398/40 = 0.190 Hect TOTAL PLOT AREA = 0.259 Hect OR TOTAL PLOT AREA = 0.64 ACRES OR TOTAL PLOT AREA = 27878 Sq. ft. PLOT SIZE BLOCK A P. No. 1-5,10,11 = 25'0" x 60' = 1500 Sq.ft. P. No. 6 = 27'3" x 60' = 1635 Sq.ft. P. No. 7 - 9(LIG) = 20'0" x 30' = 600 Sq.ft. P. No. 12 = 25'9" x 60' = 1545 Sq.ft.</p>	<p>PROPOSED LAYOUT PLAN BELONGS TO Mr. G.P.CHANDRAKAR S/o Mr. PRITHVI NATH CHANDRAKAR AT MATHPURAINA ON PLOT Kh.No.398/27,398/40 IN FRONT OF SUDA MATH PURAINA RAIPUR(C.G.)</p>
---	---

VIPIN KUMAR JHA  
(Dip in Civil Eng.)  
License No.302  
ECOCON  
Shanti Chowk  
Raipur Basti Raipur (C.G.)  
ENGINEER'S SIGN

Ghandaraker

OWNER'S SIGN

DRAWN AT:

ECOCON

Er.VIPIN JHA & ASSOCIATES  
Bldg. PLANNERS & DESIGNERS  
SHANTI CHOWK, PURANI BASTI,  
RAIPUR (C.G.) Mo.: 98 264 26888